

PURDUE TURF PROGRAM

MEETING CURRENT
AND FUTURE
INDUSTRY NEEDS

The Purdue Turf Program in partnership with the Midwest Regional Turf Foundation has a vision to build new and innovative facilities to prepare the next generation of leaders in the turf industry. These improvements will allow us to attract the best faculty and students, enhance our research, teaching, and extension efforts, and strengthen workplace safety.

TURF PROGRAM ENHANCEMENT ENDOWMENT

A new dual-use endowment called the “Midwest Regional Turf Foundation Enhancement Endowment” was created in December 2022 to house gifts and ultimately, support a building expansion initiative. The endowment may be liquidated and used for construction and renovation costs once the fundraising goal is met and the project is approved. The Midwest Regional Turf Foundation made a generous 5-year (2023-27) pledge to provide a total of \$500,000 to advance the Purdue Turf Program.



DANIEL TURF CENTER EXPANSION INITIATIVE



PU TURFGRASS CENTER STUDY | PERSPECTIVE RENDERING - SOUTHEAST
VERSION 1.0 | MARCH 18, 2022



FACILITY IMPROVEMENTS AND RENOVATIONS

6,540
SQUARE FEET OF
NEW SPACE

4
NEW
RESEARCH
SPACES

2
NEW
RESTROOMS

1
NEW PESTICIDE
MIXING &
STORAGE

STUDENT LEARNING AND RECRUITMENT

1
ACTIVE
LEARNING
CLASSROOM

480
ADDED SQ FT
OF TEACHING
SPACE

2,570
RENOVATED
SQUARE FEET
FOR RESEARCH

1
MEETING SPACE
TECHNOLOGY
UPGRADE



Horticulture and
Landscape Architecture

History

DANIEL TURF CENTER

HOME OF THE PURDUE TURF PROGRAM

Founded in 1998, on the former site of the Purdue Dairy Farm, the Daniel Turf Center's goal is to help foster sustainability and research within the turf science industry. The turf center was named to honor the lasting legacy of William H. Daniel, who was heavily involved in all aspects of turf education and research as Purdue's first turf professor and was honored by scientific societies, foundations, associations, and the Governor of Indiana for his career efforts.

The mission of the Daniel Turf Center is to serve as a hub for turfgrass research, education, and public outreach in Indiana. What distinguishes this facility from turf research plots at other Land-Grant Institutions is that the focus is not just research as the building contains a classroom that is routinely used for Extension programs, public outreach, and teaching Purdue's turf undergraduate students.

This facility, which is financially supported in part by the Midwest Regional Turf Foundation (MRTF), has provided the Purdue Turf Program an opportunity to expand its national and international research, Extension, and teaching impact.

As headquarters for one of the top turf science programs in the country, the Daniel Turf Center serves as a hub for turf research, education, and public outreach. This facility is home to an interdisciplinary team of scientists and educators who conduct over 100 experiments annually while also training over 4,000 practitioners to foster sustainability within the turf science industry.

Projects at this farm focus on turf species and cultivar studies, management trials involving pesticide and biopesticide applications, nutrient cycling and management, drought survival, as well as weed, insect, and disease biology and control. The interdisciplinary collaboration of faculty within the turf program is what

helps them more effectively serve the public and the turfgrass industry at large.

Visitors to the facility will see 100's of turfgrass varieties of at least 10 different species and research plots managed as golf course putting greens, fairways, lawns, and sports fields.

Opportunities for Improvement

The facility has served the turfgrass industry and the Purdue Turfgrass Program well since it was opened in 1998, but the program has grown since and ***changes are needed to maximize the impact of the program and the facility moving forward.***

Several key issues exist that can be summarized as:

- Lack of sufficient space to store over \$500K of specialty maintenance and research equipment as well as the needed supplies to conduct research.
- Safety issues around using the same spaces for both equipment repair and research activities.
- Inability to store and mix pesticides on-site leading to inefficient operations.
- Inadequate classroom space for Extension training and undergraduate student learning.
- Lack of space to store and process research samples (analyze, freeze, sort, weigh, etc.) resulting in lack of ability to collect some data on-site.
- Inadequate bathroom capacity including no family or unisex bathroom.
- Lack of new technology in the classroom which limits our impact and outreach.



Other Recent Purdue Turf Program Philanthropy News

RIORDAN CHAIR

Terry Riordan, Ph.D., emeritus professor at the University of Nebraska-Lincoln and a three-time graduate of Purdue made a generous donation in July 2022 to create an endowed chair in turfgrass science, the first for the Purdue program. A provision in his will provides funding for the Dr. Terrance P. Riordan Chair in Turf Science. A skilled plant breeder, Riordan previously worked for Scotts, a global leader in lawn care, before joining Nebraska's faculty in 1978. "I developed grasses and had a couple of them that did well," he says. The gift will be matched through the College of Agriculture Endowed Chair Challenge Matching Gift Program, creating a \$2.5 million endowment.



TURFGRASS CENTER STUDY | RENDERED AERIAL

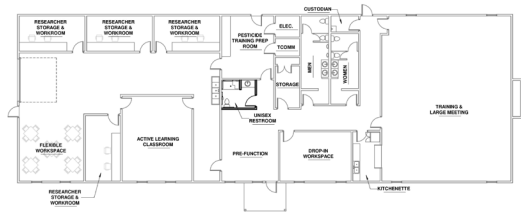
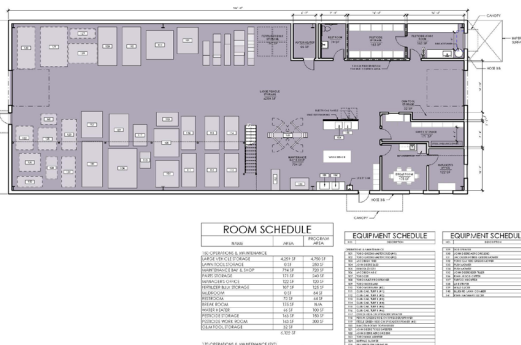

TURFGRASS CENTER STUDY | RESEARCH/TEACHING & TRAINING PLAN

Vision

TURF PROGRAM ENHANCEMENT

THE FUTURE OF THE PROGRAM

Goals of this Endowment

- Improve safety at the Daniel Turf Center by increasing space and strategically locating and defining distinct workplace functions.
- Empower faculty and staff to advance research through the improvement of functional spaces and operational efficiencies.
- Promote learning and engagement through improved spaces with greater access to varied modes of communication.

Enhancement Targets

- **Safety** – Separating maintenance, research and teaching operations into clearly defined spaces would greatly enhance safety and expand opportunities for engaging undergraduate and graduate students in the research, extension and teaching missions. It would also reduce risks associated with the transport of chemical and other potentially hazardous substances from remote locations.
- **Teaching** – Improved, dedicated turf classroom space, only steps away from our research operations, would greatly improve teaching opportunities by serving as a staging area for blended undergraduate and graduate student learning.
- **Research** – Current facilities greatly limit the efficiency of our operations,

particularly as they relate to the research mission. Materials, specialized equipment, and samples must be transported daily from on campus labs and other off-site properties to the Daniel Center. An expansion would provide ample space for on-site storage, improve access to these materials, and in doing so, increase our capacity to engage students, particularly undergraduate students who require more orientation, training and organization ahead of time, in the research mission.

- **Extension – Technology** improvements could greatly facilitate opportunities for remote extension and diagnostic programming. Simply having a space to develop new distance learning opportunities with remote technologies would be a huge advancement for us. Likewise, the expanded Operations and Maintenance facility will offer back-up, weatherproof opportunities for larger on-site extension events.

Help us Take the Next Giant Leap

Please consider coming alongside the MRTF and help support the Purdue Turf Program with a pledge of your own. All size gifts matter and will help fund this important effort.

STUDENT TRAVEL FUND

In 2021, The MRTF created a endowment to provide support for experiential learning opportunities and travel for Turf students. This endowment is used to provide funds for Sports Field Management Association (SFMA) and Golf Course Superintendents Association of America (GCSAA) Collegiate Turf Quiz Bowl Competitions and other travel experiences with the professional turf industry. The endowment has grown to over \$50K (July 2022),



FUNDRAISING GOAL
\$2.0M

MRTF CONTRIBUTION = \$500,000

In the unlikely event that a new building or the expansion of the Daniel Center can no longer be fulfilled, the University, in consultation with the MRTF, shall modify this Endowment Agreement to the extent necessary to enable the gift to be used in a manner which coincides with the MRTF's original intent as closely as possible, and which is consistent with the internal operating policies of the University.

HELP US GROW!

MEETING CURRENT
AND FUTURE
INDUSTRY NEEDS

15251

GIVING.PURDUE.EDU/APRILSHEPHERD



YES, I WANT TO HELP PURDUE

TAKE THE NEXT GIANT LEAP!



State of Indiana College Tax Credit

Indiana taxpayers may take a tax credit of half (50%) of their gift to Purdue. For a joint return, the maximum credit is \$200 (based on a gift of \$400 or more), and for a single return, the maximum credit is \$100 (for a gift of \$200 or more). The tax credit directly reduces the "bottom line" of your state income tax by reducing the amount you owe in taxes. All it takes is your gift to Purdue and one simple form: the Indiana CC-40.

Federal Tax Advantages
Contributions to the Purdue Foundation are deductible as charitable contributions within the limits of the Internal Revenue Code.

GIVE NOW

Monthly Gift* ☐ \$ _____

OR

One-Time Gift ☐ \$ _____

*We'll charge your card monthly in the amount listed by "monthly gift" until you request a change.

If you use a credit card, we will contact you prior to card expiration date to request authorization to continue your sustaining support.

PLEDGE YOUR SUPPORT // If you prefer to make a pledge and receive reminders, please complete this section.

I/We intend to make a total gift of \$ _____

It is my/our desire to pay this pledge over a period of _____ years.

Please remind me/us ☐ annually ☐ semi-annually ☐ quarterly ☐ monthly

Please send the first notice _____ (month/year)

Signature _____ Date _____

DESIGNATE

Please designate my gift as indicated below.

☐ MRTF Turf Program Enhancement Endowment [069645] \$ _____

☐ MRTF Turf Student Travel Endowment [067837] \$ _____

☐ Department of Horticulture and Landscape Architecture \$ _____

☐ Other _____ \$ _____

Please note: If your gift/pledge designation is for a new endowed fund, once your pledge is fully funded we will establish an unrestricted endowment within 90 days, in your name and of the type you have indicated, administered in accordance with our standard endowment practices and policies, until or unless an endowment agreement is completed.

PAYMENT METHOD

Thank you for your generosity. If you are making a pledge, please skip this section. Otherwise, please choose the method that is best for you.

☐ Check (made payable to Purdue Foundation)

☐ I authorize Purdue Foundation to charge my credit card/debit card

☐ VISA ☐ MasterCard ☐ Discover ☐ American Express

Card number _____ Exp date _____ Security code _____

Name on card _____

Billing address _____

City/state/zip _____

Signature _____ Date _____

☐ I anticipate that my gift will be matched by (specify company) _____

DONOR INFORMATION

Name _____

Spouse Name _____

Address _____

Email _____

City/state/zip _____

Alumna/us? ☐ Yes ☐ No Year Graduated _____

Phone _____

Name at Graduation _____

Email _____

Alumna/us? ☐ Yes ☐ No Year Graduated _____

Name at Graduation _____

Thank you for giving to Purdue!

Please mail this form and your payment to: Purdue Foundation, Gift Processing, P.O. Box 772401, Detroit, MI, 48277-2401
Questions? Email cjcoursey@prf.org or call 765-496-3545.

The Purdue for Life Foundation, structured within the Purdue Research Foundation, is an independent organization that acts for the benefit of Purdue University. Purdue Research Foundation has 501(c)(3) non-profit tax exempt status; our federal tax ID number is 35-1052049.